

# HH30 / HH50

# 3000kg / 5000kg

- ✓ for very heavy duty applications
- ✓ reinforced fork frame
- ✓ anti compression wheels



- ✓ unique design minimises pumping effort
- ✓ optional low profile forks



## Strong enough for the heaviest loads

Designed for the movement of heavy parts, machinery, tools etc

Unique hydraulic pump design: lifts up to 3 tons or 5 tons with less pumping effort

HH30 fitted with anti-compression wheels, HH50 fitted with steel wheels

Reinforced fork frame for long service life

HH30 available with optional semi low profile fork height of only 75mm

1 year parts & labour warranty

# HH30 / HH50

## Specification

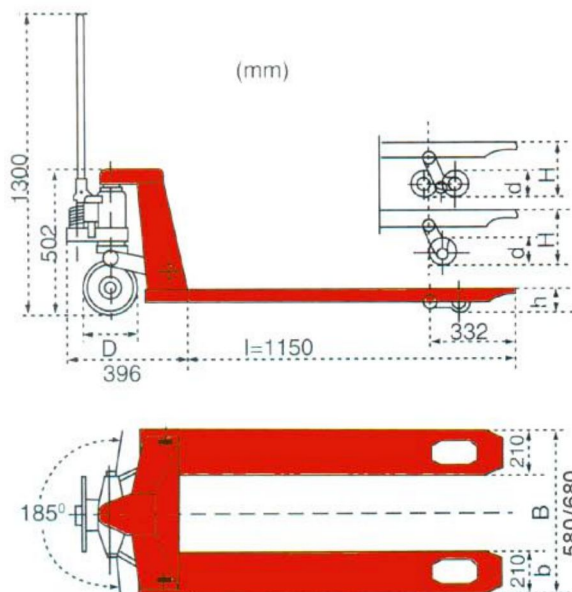
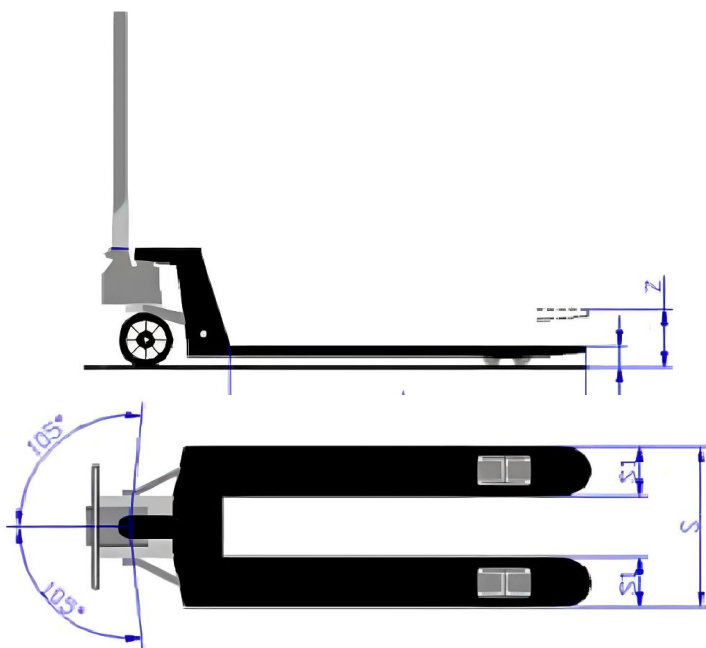

Model		HH30
Load Capacity	kg	3000
Service Weight	kg	90
Fork Height, lowered	mm	85 / 75
Fork Height, raised	mm	200 / 190
Fork Dimensions (W x L)	mm	160 x 1150
Distance Between Fork Arms	mm	540 / 680
Load Centre Distance	mm	600 max
Load Rollers		Tandem Polyurethane
Steer Wheels		Polyurethane
Entry Rollers		Nylon

Model		HH50
Load Capacity	kg	5000
Service Weight	kg	192
Fork Height, lowered	mm	90
Fork Height, raised	mm	200
Fork Dimensions (W x L)	mm	210 x 1150
Distance Between Fork Arms	mm	580
Load Centre Distance	mm	600 max
Overall Size (H x W x H)	mm	1546 x 588 x 1300
Load Rollers	mm	Tandem Steel D 80 x W 68
Steer Wheels	mm	Steel D 200 x W 50