

Twin Stacker - transporting and lifting two pallets at the same time

Use the space better and save money! The Twin Stacker can transport and stack two pallets at the same time and can operate in very confined areas, e.g. in lorries and shopping and storage areas. The Twin Stacker has small dimensions, very low own weight and is very manoeuvrable!

A unique patented system "locks" mast and propulsion unit when lifting more than 900 mm. The stacker is fully stable and safe, also when lifting. The Twin Stacker is very manoeuvrable also on uneven floors.

Twin Stacker has an elegant design with rounded corners and makes no damage to surroundings, pallets and goods. The design puts focus on the safety and ergonomic working conditions of the user. As an example the ergonomically correct handle ensures the user a relaxed hold.



Technical Specifications

Capacity

- In total 1800 kg
- On the lowest forks: Up to 1800 kg
- On the upper forks: Up to 800 kg

Perfect in confined areas

- Length behind the forks: only 655 mm
- Tight turning angle of 210°
- Narrower than the width of a EUR pallet - it can operate in aisles as narrow as a pallet width

High performance with AC technology

- Very manoeuvrable on uneven floors
- Unique patented system ensures stability when lifting more than 900 mm
- Easy maintenance and setting of e.g. driving speed and acceleration
- Long operation time per charge
- Motor brake - optimum safety

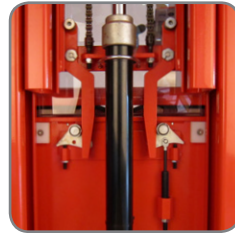

New and unique patented system ensures stability and safety when lifting.



The low overall height gives optimum view conditions.



High free height makes it easy to cross edges and operate on uneven floors.



Low own weight means better utilisation of the capacity of the lorry tail-gate.



By utilising the space better in the lorries, the number of transport tours can be reduced.

| Product (measured in mm) | | TS 1801 |
|---|-----------------|---|
| Capacity (kg) upper forks | Q ₁ | 800 |
| Capacity (kg) lowest forks | Q | 1800 - Q ₁ |
| Lifting height upper forks | h ₃ | 1770 |
| Fork length | l | 1150 |
| Overall height (lowest forks lowered/raised) | h ₁ | 1355/1475 |
| Overall width | b ₁ | 610 |
| Fork span | b ₅ | 560 |
| Fork width | e | 163 |
| Length without forks | l ₂ | 655 |
| Overall length | l ₁ | 1805 |
| Overall height | h ₄ | 2185 |
| Lowered height, forks | h ₁₃ | 85/90 (lowest forks/upper forks) |
| Lifting height lowest forks | h ₅ | 200 |
| Wheelbase | y | 1460 |
| Load centre | c | l/2 |
| Turning angle of the wheels | | 210° |
| Gangway | A _{st} | 2335* |
| Run-in length | l _x | 1126 |
| Turning radius | W _a | 1635 |
| Driving motor | | 24V 1,2 kW speed control electronically variable |
| Driving speed with/without load | | Below 730/850** mm lift: 5/6 km/h, over 730/850** mm lift: 3/4 km/h |
| Pump motor upper forks | | 24V 1,2 kW |
| Lifting speed with/without load upper forks | | 70/120 mm/s |
| Lowering speed with/without load upper forks | | 120/70 mm/s |
| Pump motor lowest forks | | 24V 1,2 kW |
| Lifting speed with/without load lowest forks | | 35/50 mm/s |
| Lowering speed with/without load lowest forks | | 115/40 mm/s |
| Weight in kg without battery | | 465 |

* Tests show that 1850 mm are enough.

** lowest forks lowered/raised

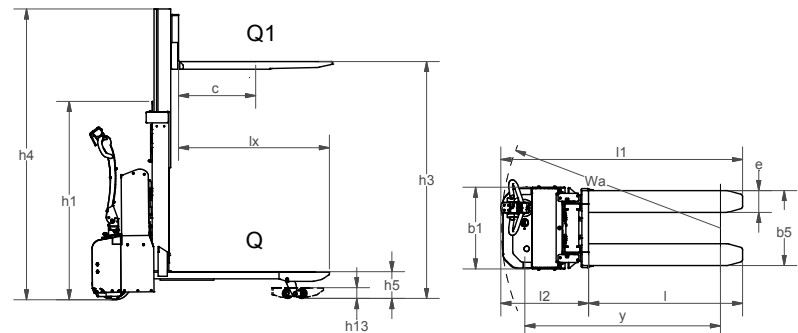

We also offer tailor-made solutions.

Please ask for further information or visit our website www.logitrans.com